

FIXING INSTRUCTIONS

GV11 SLATE VENTILATOR - FOR RETRO FIT

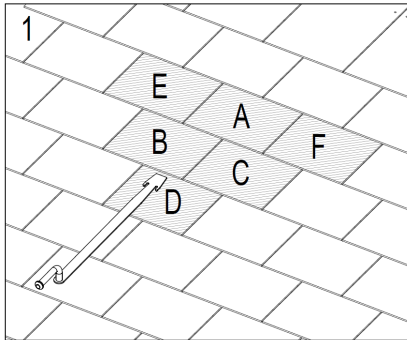

Identify approximate location for installing GV11

Using a Slaters Rip tool, remove at least 3 slates (Detail 1: slates A, B & C) to expose the roof underlay.

Identify the rafter positions, and if necessary, remove further slates (typically slates E & F) to allow correct positioning of the GV11.

Note: Ensure the ventilator is not directly above a rafter and that the batten cantilever is not excessive.

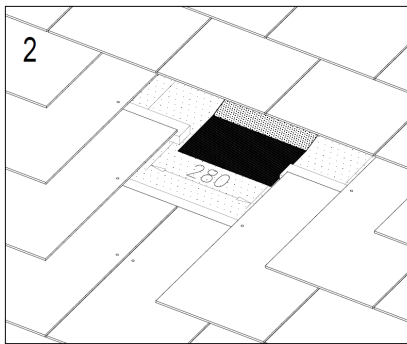

Remove and cut the slate D or slates (course dependent) directly below the proposed position of the ventilator so that the slate (s) does not protrude past the slate batten. Cut a 280mm wide gap in the batten as shown in detail 2.

Cut the underlay as shown in detail 2, folding it back to ensure a free airpath for the ventilator and pin it above the batten. For older, brittle underlays, fit the Glidevale underlay protector (supplied separately) centrally above the underlay opening as shown in detail 2a and secure to the upper, back edge of the support batten (see below).

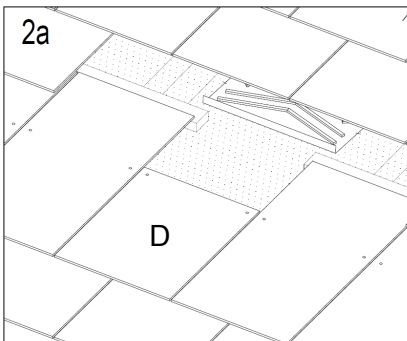

Secure an additional support batten above the cut batten (not required for slates of lengths 400mm or less). If using the Glidevale underlay protector, secure it to the upper, back edge of this support batten.

Position the ventilator central to the slate below and level with the bottom edge of the adjacent slates. Nail the ventilator to the support batten. (see detail 4 overleaf).

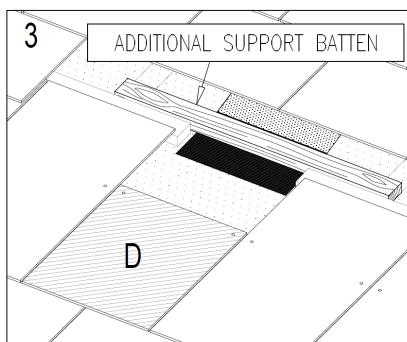

Cut slates B & C to fit either side of the ventilator so that they neatly abut the grille and central upstand. Add a hole to each slate piece as shown in detail 5 overleaf ensuring that it is twice fixed to the battens – appropriate slate hooks or crampion disk rivets may have to be used.

The slate in the course above the grille (slate A) will need to be cut such that it stops level with the top of the ventilator grill (see detail 6 overleaf). This slate will need to be secured with a slate hook fixing or tie strap.

FIXING INSTRUCTIONS

GV11 SLATE VENTILATOR - FOR RETRO FIT

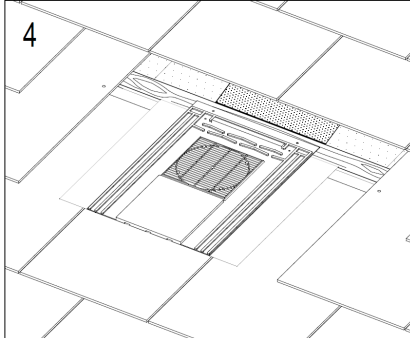

Alternatively, the ventilator position may be ideally located centrally over the gap between the 2 slates below the proposed ventilator position. Remove and cut the slates directly below the proposed position of the ventilator so that the slates do not protrude past the slate batten. Cut a 280mm wide gap in the batten as shown in detail 2.

Cut the underlay as shown in detail 3, folding it back to ensure a free airpath for the ventilator and pin it above the batten. For older, brittle underlays, fit the Glidevale underlay protector (supplied separately) centrally above the underlay opening as shown in detail 2a and secure to the upper, back edge of the support batten (see below).

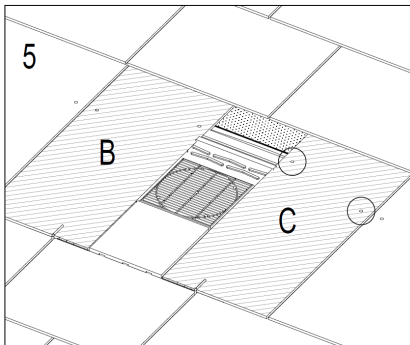

Secure an additional support batten above the cut batten (not required for slates of lengths 400mm or less). If using the Glidevale underlay protector, secure it to the upper, back edge of this support batten.

Position the ventilator central to the slates below and level with the adjacent slates. Nail the ventilator to the support batten. (see detail 4).

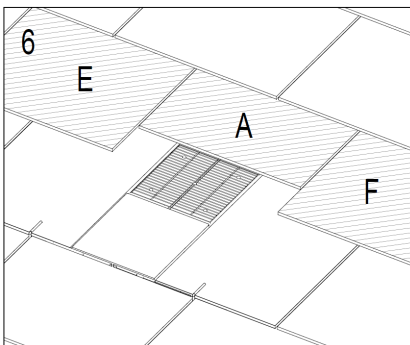

Due to the position of the ventilator, it will be necessary to use 2x slate and a half pieces (typically 600 x 450mm). Cut the two wider slates to fit either side of the ventilator so that they neatly abut the grille and central upstand. Add an additional hole to each slate piece as shown in detail 5 ensuring that it is fixed twice to the standard battens and once to the support batten section – appropriate slate hooks or crampion disk rivets may have to be used, (an additional hole for a crampion disk rivet will also be required, this should line up with the gap between the slates in the course below).

The slates in the course above the grille will need to be cut such that they can be positioned neatly around the top of the ventilator grill. These slates will need to be secured with a slate hook fixing or tie strap.

GLIDEVALE

2 Brooklands Road, Sale, Cheshire, M33 3SS

Telephone: (+44) 0161 905 5700 Fax: (+44) 0161 905 2085 Web: www.glidevale.com Email: info@glidevale.com



A division of Building Product Design Ltd. Company Registration No: 3944123